

WPC slot-in fencing

# TURINO



Original installation instructions



## CONTENT

Safety instructions	2
Symbols and pictograms	2
Storage and principles of assembly	3
Preparation for mounting	3
Assembly tools / Required items	4
Mounting the posts	5
General rules for alignment	5
Mounting with L-brackets	6
Troubleshooting	7
Care and cleaning	7
Waste disposal and environmental protection	7
Warranty conditions	7



Please read these operating instructions completely and carefully. These instructions are part of this product and contain important information on installation and handling. Always observe all safety instructions. If you have any questions or are unsure about the handling, please contact your dealer. Please keep these instructions in a safe place and pass them on to third parties if necessary.

## SAFETY INSTRUCTIONS

- Please read these instructions carefully before installation and keep them for future reference.
- Check the packaging and make sure that you have received all the listed parts.
- Do not leave packaging material lying around carelessly. It could be dangerous if played with by children.
- Select a suitable mounting location for your product.
- While preparing the mounting holes, be careful not to drill or dig into any conduits or power cords below the surface.
- If you are unsure about the installation, ask a specialist for advice.

## SYMBOLS AND PICTOGRAMS



General warning symbol - Be alert and observe common hazards.  
This warning symbol is displayed in conjunction with other signs or symbols.  
Failure to observe this warning may result in injury or damage to the product.



Command sign (instead of an exclamation mark, the command may be explained) with information on how to prevent damage.



Indicator with information for better handling of the product.



Action symbol - Read this manual carefully and completely.

# STORAGE AND PRINCIPLES OF ASSEMBLY

## STORAGE BEFORE INSTALLATION

Before installation, store all WPC elements in a dry place which is protected from sunlight and at the same temperatures as outside on the installation site. This serves to acclimatize the WPC elements to avoid unfavorable stresses. Please pay special attention to the regulations for fence storage.

- Do not store the planks in an inclined position; store in a horizontal or vertical position to avoid bending or breaking.
- The planks should be handled with special care as they are very heavy.

## GENERAL PRINCIPLES

The materials and properties of WPC and wood differ. Process and use WPC only according to the instructions, otherwise possible product defects or injuries may occur. We are not liable for any consequences arising from the failure to observe this instruction.

All illustrations and instructions in this guide are for reference purposes only. All construction work must be carried out in accordance with local laws and building regulations.

At each stage of construction, especially when cutting the profiles, please make sure that you are equipped with protective clothing and protective equipment such as safety goggles, gloves, mask, etc. We are always at your disposal in case of questions or problems

# PREPARATION FOR MOUNTING

## HANDLING



**IMPORTANT!** This exclusive fence has been designed for use with the boards in a horizontal position. Ensure that the footing is adequate to carry the weight of the fence.

**IMPORTANT!** Compared to wood, WPC has a higher specific weight and greater elasticity. Special care must be taken during handling. When handling WPC profiles, please note that their weight differs from that of normal construction timber.

## LEGAL INFORMATION



**IMPORTANT!** Ensure that the fence is installed in accordance with local laws and relevant regulations.

## ASSEMBLY TOOLS

Standard tools for woodworking:

Hand or table saw, cordless drill, angle grinder, drill



Other assembly tools:

Spirit level, measuring tape, plumb bob, screwdriver, pencil for marking, calculator



## TURINO SLOT-IN FENCING

consists of the following elements:

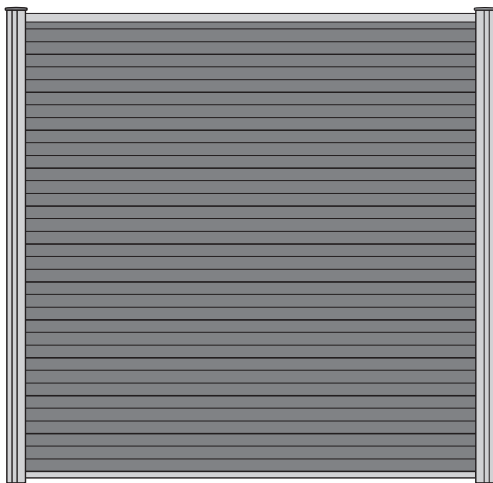

### Aluminum posts

anodized, 68 x 68 x 2,400 mm

2 cover strips

3 spacers

1 post cap

The posts can also be used as corner posts.

The uncovered post grooves can be covered using the supplied strips.

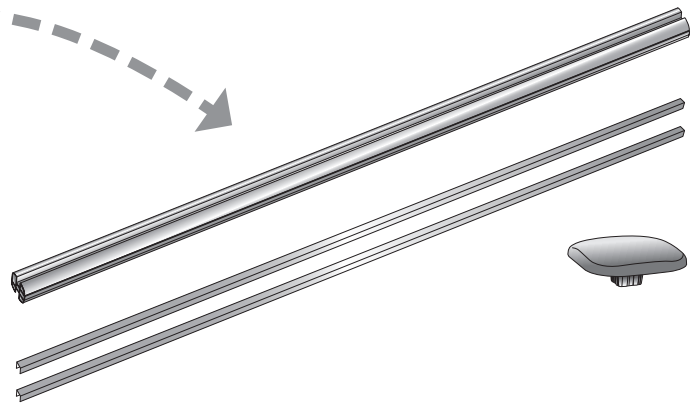

### WPC boards

20 x 150 x 1,773 mm

Wrapped in film in sets of 6

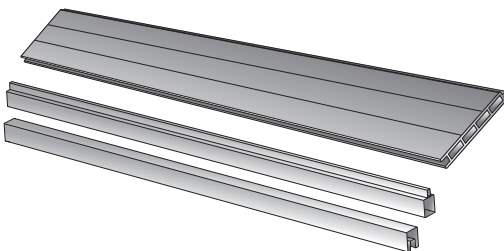

Set

### Aluminum start and end plate

with 4 brackets and screws for securing

into the groove of the post,

anodized, 25 x 22 x 1,790 mm

The posts can be shortened to a customized fence height but make sure to take into account the length required for setting in concrete.

# MOUNTING THE POSTS



## SET THE COURSE

- Plan and mark the position of the fences to be erected, particularly the position of the posts. The distance from post center to post center must be 1,800 mm.
- The width of the self-assembly sets available in the standard sizes 180 x 180 cm (WxH) can be customized by shortening the individual components.
- The course of the fence can be diverted 90° at the posts.
- To allow for a linear expansion due to temperature fluctuations, the WPC boards must be 0.7 cm shorter than the aluminum start and end plates. The slight expansion of the WPC boards is then compensated by the grooves in the posts.

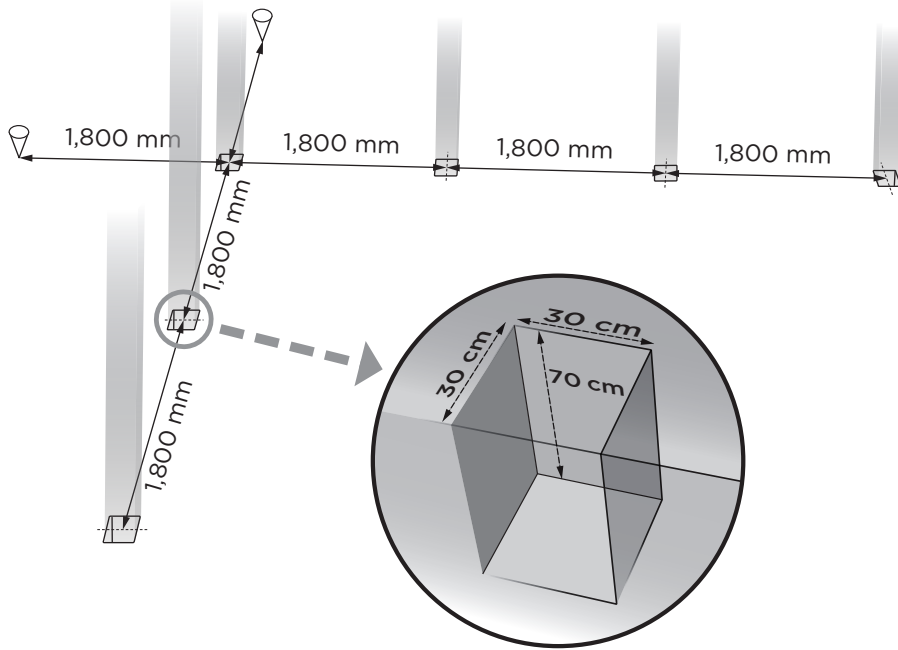

## LAY THE FOUNDATION

For installation on soft ground, the posts must be set in concrete, whereby the size of the post hole filled with concrete should be at least 30 x 30 x 70 cm to guarantee optimum stability in strong winds.



**NOTE!** The aluminum posts should also be anchored into the concrete. To do so, drill a hole approx. 30 cm deep into the post and attach a piece of steel wire to it.



**ATTENTION!** It is very important to make sure that the posts are exactly vertical and at the correct height before you start the installation. This lays the groundwork for a precise assembly and gives your privacy fence the professional look. See section **SET THE COURSE**.

## GENERAL RULES FOR ALIGNMENT

It is strongly recommended that the fence is mounted in such a way that it does **not rest** on the ground.

## MOUNTING



- 1 First, make sure that the posts are completely vertical, are at the correct height and have the correct spacing. Use the length of the start and end plates to determine the correct spacing between the posts. The distance is 180 cm from post center to post center.
- 2 When setting the posts in concrete, the concrete must be filled up to the bottom edge of the spacers to ensure they are adequately supported once the concrete has set. Wait until the concrete has set before continuing with step 3.
- 3 After temporarily removing the post cap (do not lose it!), you can start mounting the individual components. First, place the aluminum end plate with the guide facing upward onto the spacer in the grooves of the posts. The spacers must be secured horizontally on both sides (left and right) and at the same height to facilitate the horizontal attachment of the planks.
- 4 Now slide down the first WPC board of 20 x 150 mm. Repeat the process until the desired fence height is reached.
- 5 Seal the top with an aluminum start plate with the guide facing downward.
- 6 After this, you can refit the post caps.
- 7 Once installed, the fence should be cleaned using a suitable WPC cleaner to remove any dirt and production residues.

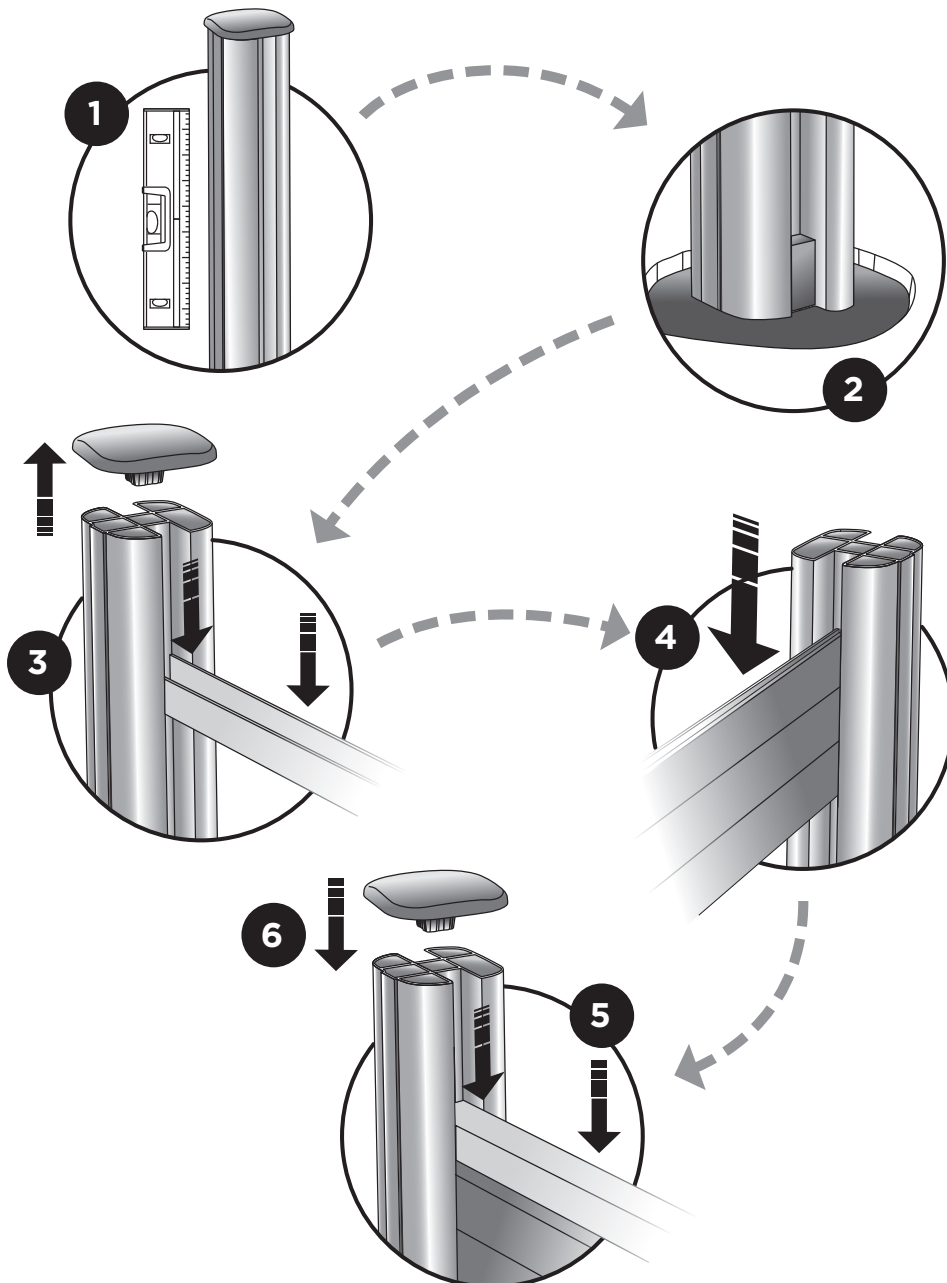



## TROUBLESHOOTING

PROBLEM	CAUSE	SOLUTION
Height difference (planks are not horizontal)	Spacers are not affixed horizontally at the same height.	Check the spacers as described under <b>Mounting (Point 3)</b> .

## CARE AND CLEANING

All building materials for outdoor applications must be cleaned. In general, household cleaners (soap or detergent) and water are sufficient for cleaning WPC products.

PROBLEM	SOLUTION
Dirt	To remove dirt from the surface, use warm soapy water and a soft brush.
Ice and snow	Use a soft brush to remove snow from the fence element.
Oil and grease	Briefly rinse the affected area with water. Then clean with warm soapy water and a soft brush.
Mildew	If deposits on the fence are not removed quickly enough, residues such as pollen can turn into mold. Your fence should therefore be cleaned at regular intervals. If mold is already present, remove it with warm soapy water and a soft brush.

## WASTE DISPOSAL AND ENVIRONMENTAL PROTECTION

Dispose of the product at the end of its service life in accordance with the applicable legal regulations.

## WARRANTY CONDITIONS

This product is covered by statutory warranty.

Claims must be filed as soon as they are established. The right to warranty claims expires in case of interventions by the buyer or third parties. Damage due to incorrect handling or use, incorrect placement or storage, improper connection or installation, as well as due to force majeure or external influences is not covered by the warranty. We recommend that you read these operating instructions carefully as they contain important information.

Our products consist of approx. 60% wood fibre/wood flour. Wood is a natural material and for this reason there may be slight colour deviations despite the consistent processing and addition of colour agents. This does not constitute grounds for complaint.

### Notes:

1. If the product does not work, check that it is being used in line with the intended use.
2. Please enclose the following documents if you are returning a faulty product:
  - Detailed description of the problem.



## PRIVACY FENCES MADE OF WPC

BEAUTIFUL AS WOOD, EASY TO CLEAN AS PLASTIC

WPC (Wood-Plastic-Composite) combines the advantages of wood and plastic in the most impressive way. In a special process, wood fibers are refined with recycled plastic. The main component, at almost 60%, is wood fibers.

This means the look and feel of wood is kept, combined with the longevity and ease of care of plastic.

The material is weather resistant, keeps its shape, is environmentally friendly and can be recycled. It does not splinter or crack and is ideal for outdoors. The weather resistance of WPC, thanks to the low water absorption and high UV resistance, is seven to ten times greater than for a pure timber product.

Our product range includes privacy elements with different design lines from the **ROMA, MADRID, IBIZA** and **PALMA** series as well as the slot-in fencing systems **VERONA, MILANO** and **LIVORNO**.



For more inspiration from WPC, visit [www.dws-gmbh.de](http://www.dws-gmbh.de)



DWS GmbH  
Heidestraße 90  
25462 Rellingen, Germany  
Fon: +49 (0) 4101 - 84 51 838  
Fax: +49 (0) 4101 - 84 51 839  
E-Mail: [info@dws-gmbh.de](mailto:info@dws-gmbh.de)